

NON-PMA REMOTE TAIL POSITION+STROBE LIGHT ASSEMBLY FOR ULTRA-LIGHTS • HOME-BUILTS • EXPERIMENTAL AIRCRAFT

KIT # 156-0029*

Specifications, Wiring & Spare Parts Guide

*add correct suffix when ordering:

- *SF-12 is 12v Single Flash (45 flashes per min.)
- *DF-12 is 12v Double Flash (72 flashes per min.)
- *RF-12 is 12v Single Flash (72 flashes per min.)
- *SF-24 is 24v Single Flash (45 flashes per min.)
- *RF-24 is 24v Single Flash (72 flashes per min.)

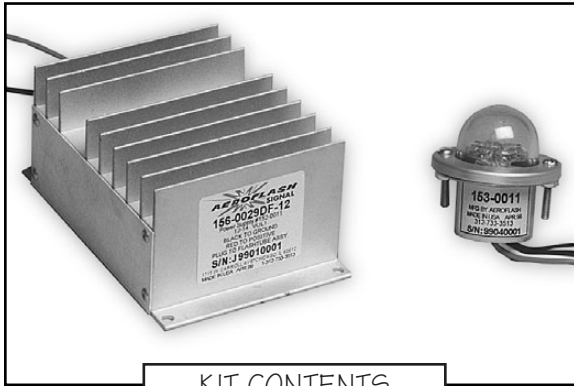

KIT CONTENTS

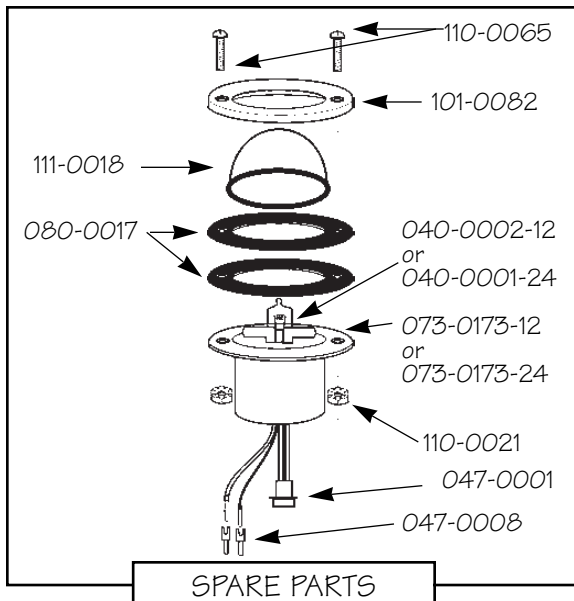
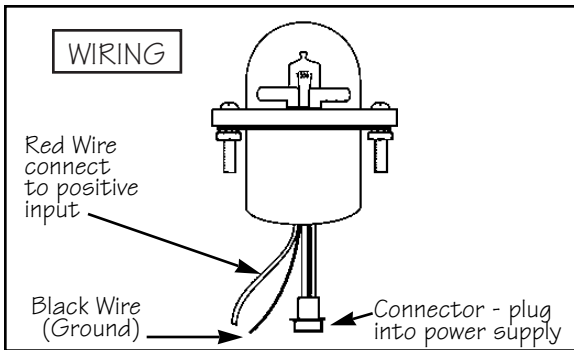

KIT CONTENTS & SPECS

Lamp Assembly (Clear Lens).....1

Part No.	Description	Weight
153-0011-12	Lamp Assembly for 12 volt systems	3.5 oz.
153-0011-24	Lamp Assembly for 24 volt systems	3.5 oz.

Dimensions for the Lamp Assembly:

- Housing.....1-5/16" Dia.
- Flange.....2-3/16" Dia.
- Height2-1/4" (from bottom of housing to top of dome)

Power Supply1

Part No.	Description	Amp Draw	Weight	Flashes per Minute
152-0007	12-Volt Single Flash	2.0 amps	1.33 lbs.	72
152-0011	12-Volt Double Flash	3.0 amps	1.33 lbs.	72
152-0012	12-Volt Single Flash	2.0 amps	1.33 lbs.	45
152-0010	24 -Volt Single Flash	1.0 amps	1.25 lbs.	72
152-0014	24-Volt Single Flash	1.0 amps	1.25 lbs.	45

Specifications for the power supplies:

- Dimensions.....5 1/2" long x 3 11/16" wide x 2 1/2" high
- Output.....10 Joule

WIRING

(Refer to Diagram)

RED WIRE (lamp) - Connect to positive input or to switch.

BLACK WIRE (lamp) - Connect to ground.

CONNECTOR Operates the strobe lamp. This plugs in directly to the Power Supply.

POWER SUPPLY Red Wire to positive input or a switch. Black wire to ground.

SPARE PARTS LISTING

Part No.	Description
110-0065	6/32" x 1" Screws (2)
101-0082	Hold Down Ring
111-0018	EMI-Coated Clear Glass Dome
080-0017	Rubber Gaskets (2)
073-0173-12	Replacement flashtube w/Position Lamp-12-Volt
073-0173-24	Replacement flashtube w/Position Lamp-24-Volt
040-0002-12	Replacement 12-Volt Position Lamp
040-0001-24	Replacement 24-Volt Position Lamp
110-0021	1/8" Lock Nuts (2)
047-0001	Male 3-Pin Connector (from flashtube)
047-0008	Wire Connectors (2)

*For power supplies, see above.
Custom cable assemblies are available*



Questions? Call us between 6:00 a.m. - 2:30 p.m. CST

Technical Support . . . 1-312-733-3513 Ext. 121

Sales 1-800-322-2052 Ext. 101 (Toll-free in the USA)

1-312-733-3513 Ext. 101 (Local & Intern'l)